



1250-1280 P / D, Quick guide

This guide is intended for quick consultation only and does not replace the user and maintenance manual.

Before using the machine, read the user and maintenance manual contained in the machine's packaging thoroughly and strictly follow all the instructions.

PREPARATION & OPERATION

Pull the STARTER lever.

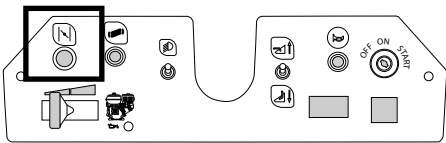

Move the engine speed control lever to the maximum position on the right.

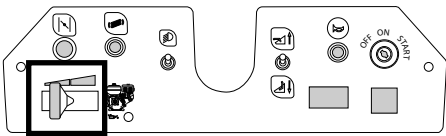

Move the lever to the "START" position and hold it there.

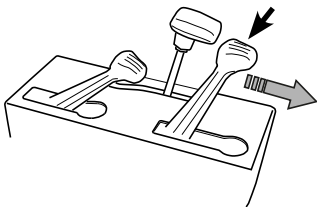

Switch the machine on by turning the ignition key to START, when the engine starts release the key in the ON position and release the lever that had previously been held in the "START" position.

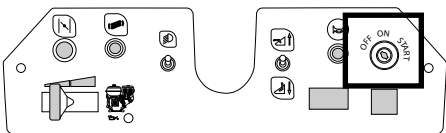

Lower the main brush.

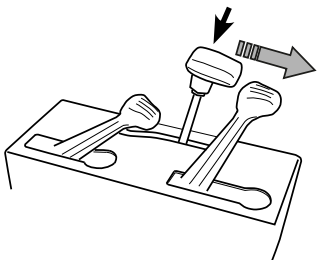

Lower the side brushes.

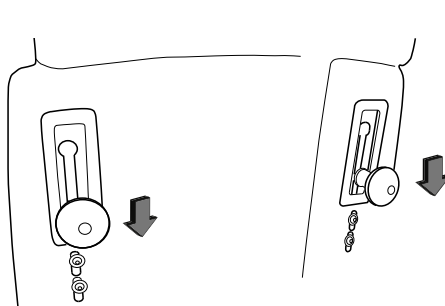

Activate suction using the lever, adjusting air flow to ensure suction of the dust. Do not use suction on wet surfaces.

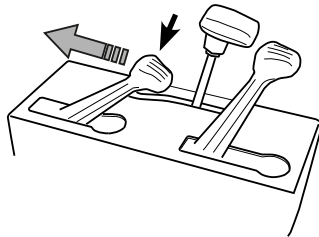

Press the accelerator pedal to start travel, pressing it to the right the machine will move forwards, pressing it to the left the machine will move backwards.

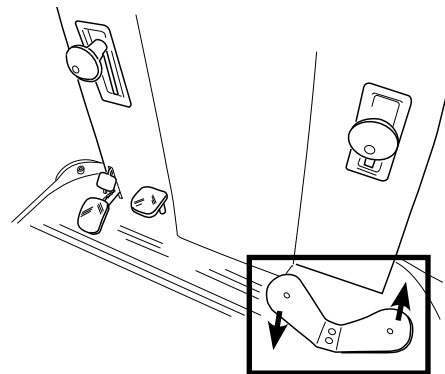

To collect voluminous objects, press the front flap lift pedal

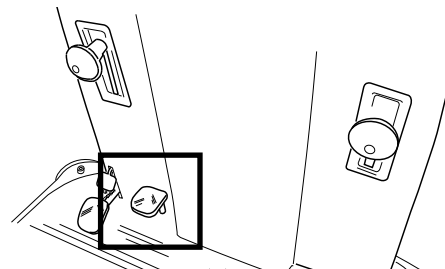

To stop the machine, press the brake pedal, which also acts as parking brake, using the special locking lever.

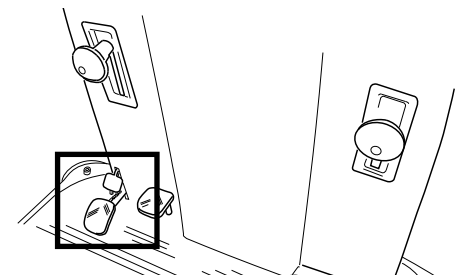

Emptying the bottom unloading debris bin, model 1250:

- Release the bin lock.
- Pull out the rear bin by means of its handle.
- Take the bin (which is fitted with wheels) to the rubbish collection point and empty it.

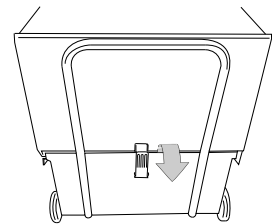

Emptying the bottom unloading debris bin, model 1280:

- Lift the bin to the desired height, holding the enabling button and moving the selector located on the instrument panel.
- Pull the lever to rotate the bin and empty its contents.

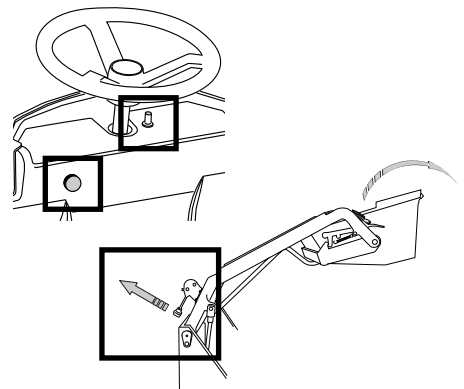



DAILY MAINTENANCE

When you have finished cleaning, proceed as follows:

- Switch the machine off, after having moved the engine speed lever to the minimum position.
- Activate the parking brake.
- Raise the centre brush and the side brushes, to prevent damage.

CLEANING THE DUST FILTER

Deactivate suction using the lever.

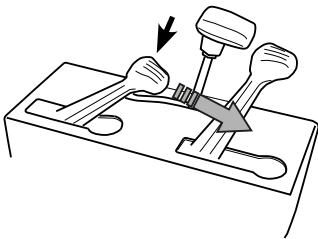

Activate the filter shaker for 10 seconds using the corresponding button.

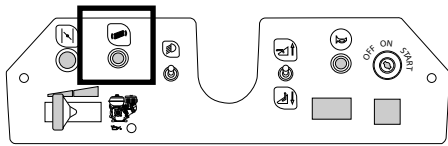

Empty the debris bin.

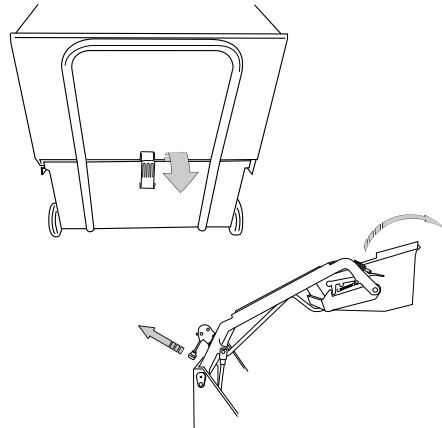

Check and remove any debris wrapped around the side brushes and on the centre brush.

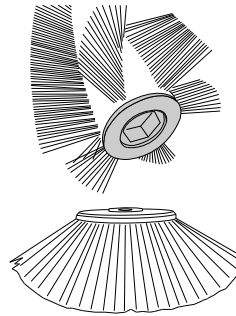

WEEKLY MAINTENANCE

Check that the suction filter is tight and clean.

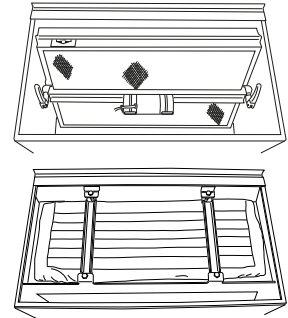

REPLACING THE CENTRE BRUSH

- Unscrew the knob and open the door on the left of the machine.
- Unscrew the three knobs securing the brush compartment cover.
- Pull out the brush cover compartment.
- Remove the brush, holding it on the plastic core.
- Remove the adapter from the core of the old brush and fit it to the new brush, taking care to keep the bristles aligned in the same direction.
- Fit the new brush and make sure that the adapter is inserted on the drive hub.
- Replace the brush compartment cover using the knobs, following the dismantling operations in reverse order.

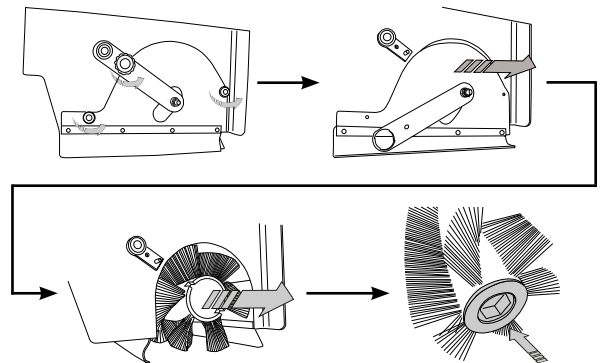

ADJUSTING CENTRE BRUSH PRESSURE

- Unscrew the knob indicated.
- Turn the lever anti-clockwise to increase pressure, making sure to align the knob fastening hole.
- Screw the knob back on.

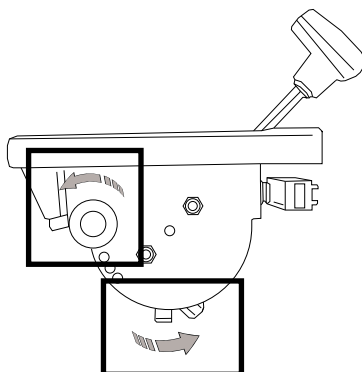

ADJUSTING SIDE BRUSH HEIGHT

- Move the side brushes to the working position.
- Loosen the two adjustment screws underneath the brush lifting knob.
- Manually move the brush to the required position.
- Tighten the adjustment screws.

